

AIP HONG KONG

AD 2-80B
18 August 2016

AERODROME CHART
(VISUAL MARKINGS)

ARP 22° 18' 32.11"N
113° 54' 52.57"E

ELEVATION 28 FT AMSL

TWR 118.2 (North Runway)
118.4 (South Runway)

GMC 121.6 (North)
122.55 (South)

VHHH / HONG KONG
INTERNATIONAL AIRPORT

ELEVATIONS IN FEET AMSL
DIMENSIONS IN METRES
BEARINGS ARE MAGNETIC

HOTSPOT
Do not confuse
TWY A with RWY 07L

VAR 2W (2010)

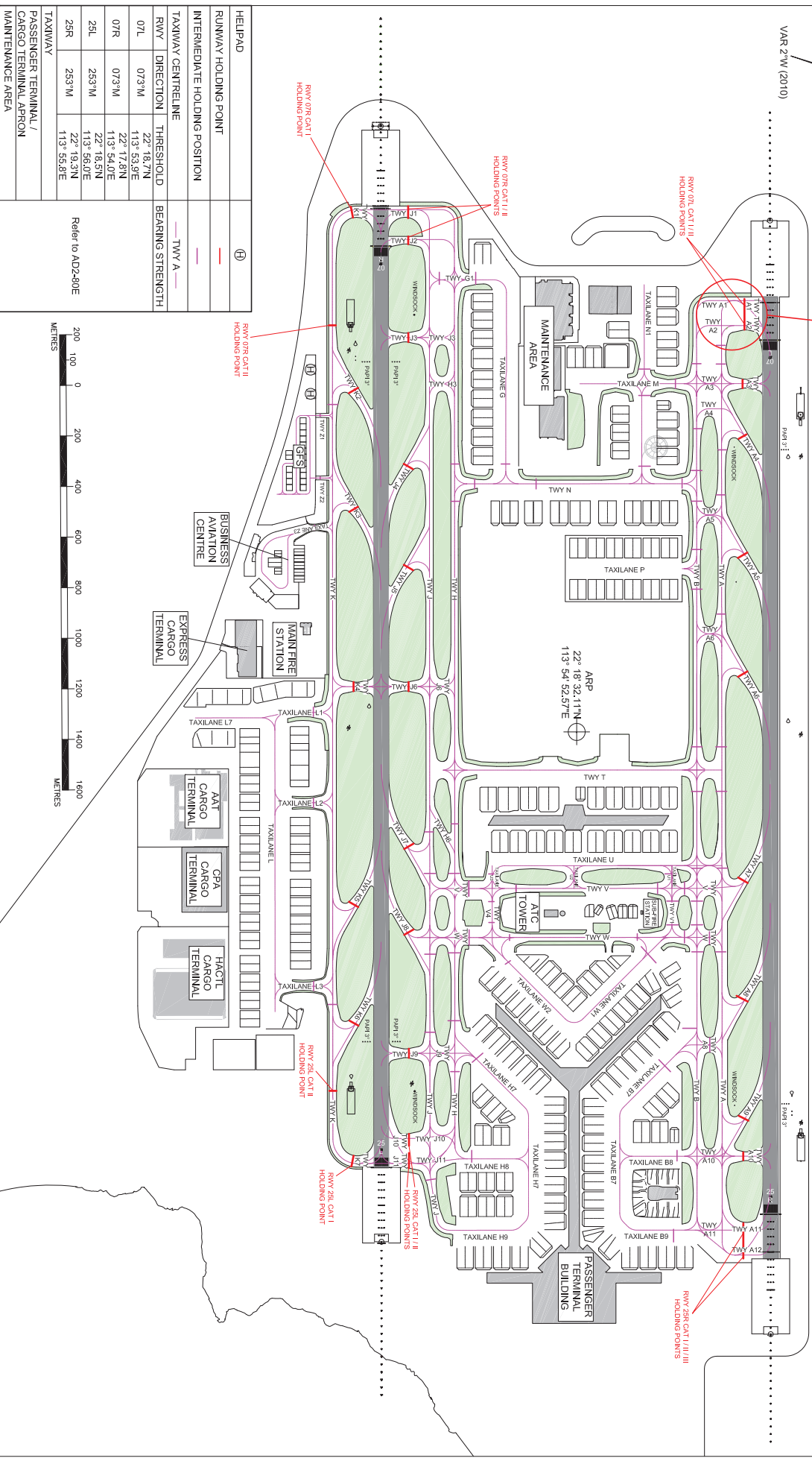

HELIPAD			
RUNWAY HOLDING POINT			⊕
INTERMEDIATE HOLDING POSITION			—
TAXIWAY CENTRELINE			— TWY A —
RWY DIRECTION	THRESHOLD		BEARING STRENGTH
07L	073°M	22° 18' 7"N 113° 53.9'E	
07R	073°M	22° 17.8"N 113° 54.0'E	
25L	253°M	22° 18.5"N 113° 56.0'E	
25R	253°M	22° 19.3"N 113° 55.8'E	
TAXIWAY			Refer to AD2-80E
PASSENGER TERMINAL / CARGO TERMINAL APRON			
MAINTENANCE AREA			



Civil Aviation Department Hong Kong

AD2-80B_V18_180712ZK